

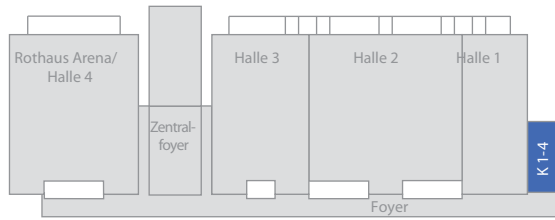





K 1 – 4



Konferenzraum 1-4 – Konferenzbestuhlung Einzelbelegung

-  Aufzug
-  Technische Einrichtungen
-  Säulen
-  Stühle
-  Tische

Technik:
Telefon (analog, ISDN, S0)
W-Lan
Klimatisierung
Verdunkelung

K1 100 m²

48 Plätze

K2 60 m²

36 Plätze

K3 60 m²

36 Plätze

K4 80 m²

40 Plätze

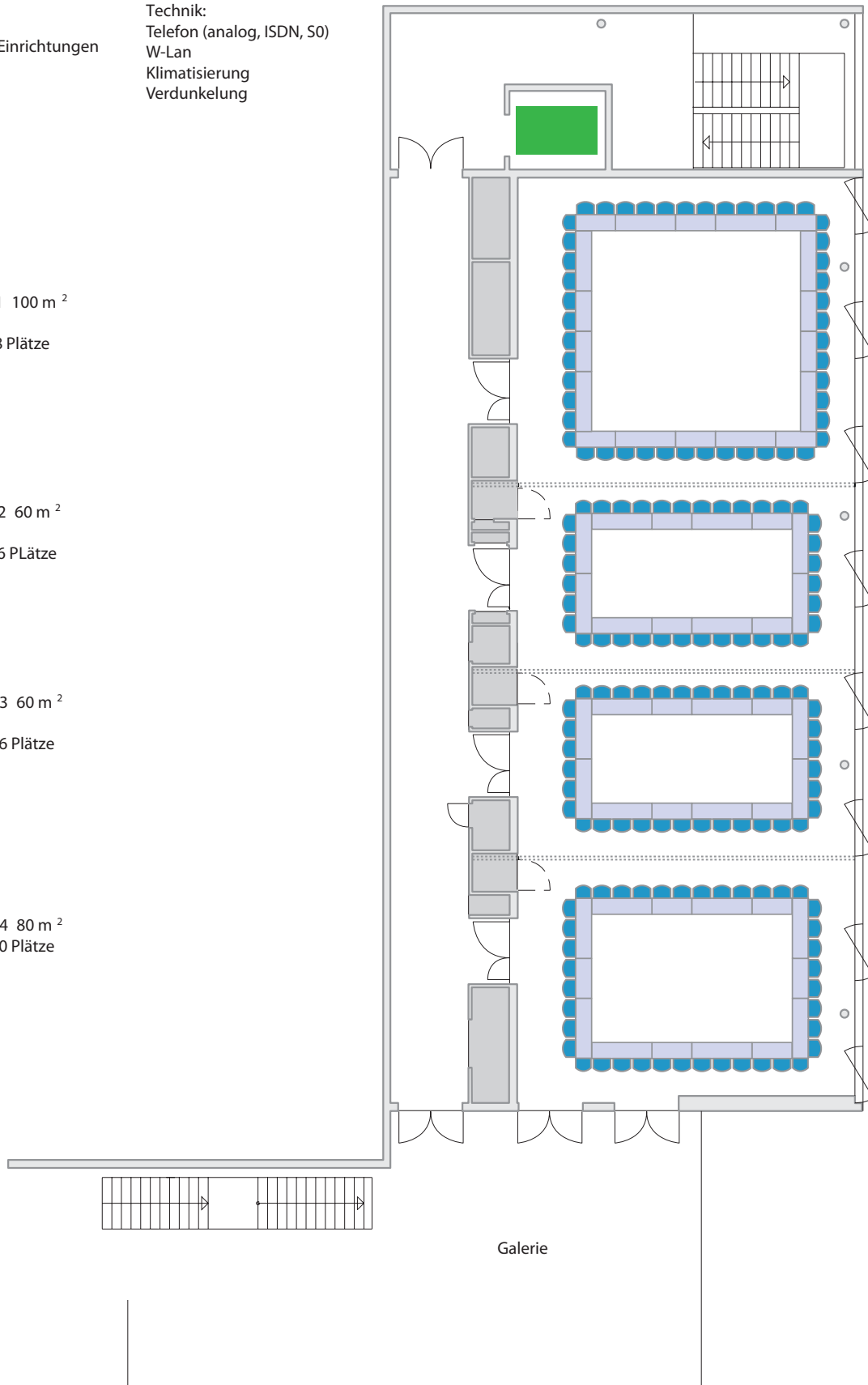

Galerie